

# Trusted multifunctional, with versatile end-to-end document capabilities

The imageRUNNER ADVANCE 4500i series is a robust, dependable office multifunctional that will benefit any small working group by improving their day-to-day workflows.

## Workflow Efficiency

- Intuitive user interface with a large, colour touchscreen provides users with smartphone-like usability, making navigation a breeze.
- Single-Pass document feeder option provides effortless, rapid scanning with features like multi-sheet feed detection and skip blank originals.
- My ADVANCE enables a unique, personal experience tailored to meet each user's workflow needs. Settings, such as display language, initial log-in screen, and accessibility options, can be synchronised across multiple devices for consistency.
- Canon's MEAP platform provides process optimisation, by integrating with a range of powerful document, capture and output management solutions.
- Scalable support for mobile where users can connect directly to the device with Direct Access Point. Capture, scan or print documents easily with the Canon Print Business app.
- Intelligent Recovery wakes device from sleep mode when user is approaching device via motion sensor technology.
- Wide range of finishing functions such as Staple-on-Demand, ECO-Staple, booklet, folding, double/corner stapling are available as an option for versatile document creation.

## Cost Management

- The ability to apply print policies, monitor output, and restrict usage by user helps reduce unnecessary printing, resulting in lower total document cost.
- Tight integration with output management solutions, such as uniFLOW, provides the ability to carry out detailed tracking, reporting, and cost analysis.
- Quality and reliability, combined with remote diagnostics and assistance, can help reduce costs by minimising downtime and time spent by IT resolving issues.
- Consistent user operation combined with remote and centralised fleet management can help simplify IT management of devices and entire fleets.



## Security

- Control who has access to the device with user authentication without impacting on user productivity or convenience.
- Prevent unauthorised distribution of sensitive information with an array of standard and optional document security features.
- Ensure information privacy and security across your network with IPsec, port filtering capabilities, and SSL technology.
- Secure Print and Mailbox enhance document confidentiality

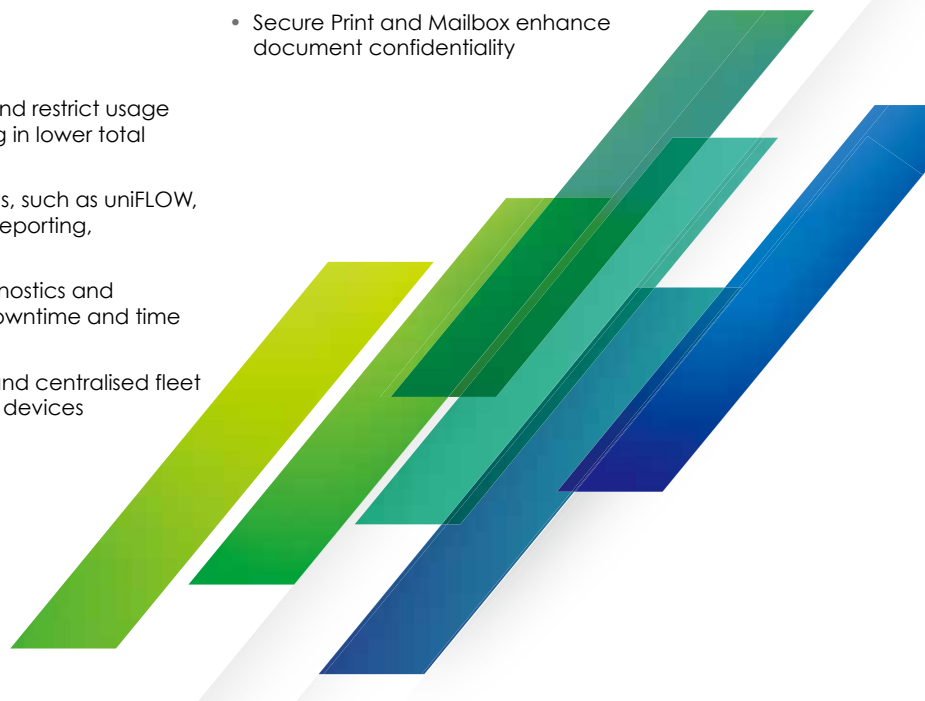

## Device and Fleet Management Efficiency

- Synchronise personalised user settings across multiple devices through My ADVANCE Sync.
- Canon's device management tools give you a centralised point of control across your entire fleet, upgrade devices remotely, check device and consumables status and capture meter readings.
- Standard PCL and optional Adobe® PostScript® 3™ print driver allows seamless integration with enterprise applications.
- Remote diagnostics allow timely, accurate and effective resolution.
- Intuitive user maintenance videos and status notifications available to help achieve maximum uptime and keep supplies replenished.

## Reliability

- Canon's signature reliability and engine technologies contribute to high-quality output to meet the needs of busy departments.
- State-of-the-art imaging technologies and toner allow for consistent images in rich black-and-white tones and 1200-dpi print resolution.
- Designed to achieve maximum uptime with status notifications to help keep supplies replenished. These models also include intuitive user maintenance videos and the ability to replace toner on the fly.
- Maximum paper capacity of 6,330 sheets reduces downtime.

## Sustainability

- Canon's innovative Quick Fixing (QF) toner enables high quality fixing at low temperature and pressure, reducing power consumption and optimise productivity.
- Minimise waste by holding jobs at the device with Force Hold Print. Choose to preview your print jobs or even change print settings at the device to achieve the desired results at the first time of printing.
- Incorporates sustainable design, with the use of recycled materials and biobase plastic, and a focus on minimising environmental impact.
- Consumes as little as 0.9W in sleep mode.

## Configuration

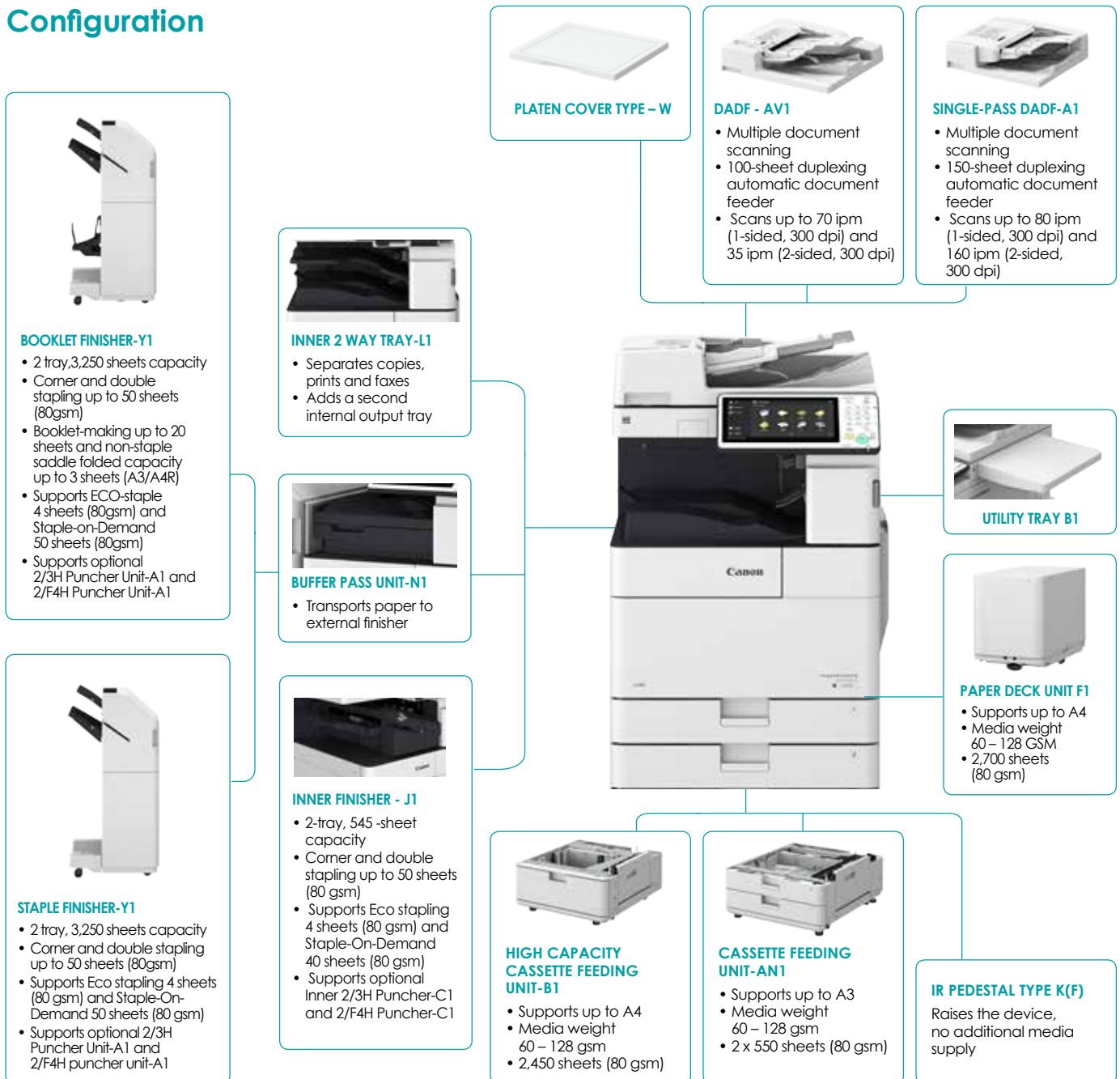

## MAIN UNIT

Type  
Monochrome Laser Multifunctional

Core Function  
Print, Copy, Scan, Send, Store and Optional Fax

Processor  
Canon Dual Custom Processor (Shared)

Control Panel  
Standard : 10.1 inch TFT LCD WSVGA Colour Touch Panel

Memory  
Standard : 3.0GB RAM

Hard Disk Drive  
Standard : 250GB  
Maximum: 1TB

Mirroring Hard Disk Drive  
Optional 250GB, 1TB

Interface Connection  
**Network** Standard: 1000Base-T/100Base-TX/10Base-T,  
Wireless LAN (IEEE 802.11 b/g/n)  
Optional : NFC, Bluetooth  
**Others** Standard: USB 2.0 x2 (Host), USB 3.0 x1 (Host),  
USB 2.0 x1 (Device)  
Optional : Serial Interface, Copy Control  
Interface

Paper Capacity (80gsm/A4)  
Standard : 1,180 Sheets  
Maximum: 6,330 Sheets

Paper Sources (80gsm/A4)  
Standard : Two 550-sheet Paper Cassettes  
80-sheet Multi-purpose tray  
Optional : **CASSETTE FEEDING UNIT-A1**:  
Two 550-sheet Paper Cassettes

**HIGH CAPACITY CASSETTE FEEDING UNIT-B1**:  
2,450-sheet Paper deck  
**PAPER DECK UNIT-F1**:  
2,700-sheet Paper deck  
Maximum: 6,330 Sheets

Paper Output Capacity (80gsm/A4)  
Standard : 250 Sheets  
Maximum: 3,350 Sheets  
(with STAPLE FINISHER-Y1/BOOKLET FINISHER-Y1)

Finishing Capabilities  
Standard : Collate, Group  
With Inner Finisher option: Offset, Collate, Group, Staple,  
Hole Punch\*, ECO-Staple, Staple-On Demand  
With External Finisher option: Offset, Collate, Group, Staple,  
Hole Punch\*, Saddle Stitch\*\*, ECO-Staple,  
Staple-On Demand

\*Require inner hole puncher option  
\*\*Require Booklet Finish-Y1 option

Supported Media Types  
**Cassettes (1/2):**

Thin paper, Plain paper, Thick paper, Colour paper,  
Recycled paper, Pre-punched paper

Multi-Purpose Tray:  
Thin paper, Plain paper, Thick paper, Colour paper,  
Recycled paper, Pre-punched paper, \*Transparency,  
Tracing paper, Label, Bond paper, Envelope

**Cassette Feeding Unit-A1 (3/4):**  
Thin paper, Plain paper, Thick paper, Colour paper,  
Recycled paper, Pre-punched paper

**High Capacity Cassette Feeding Unit-B1:**  
Thin paper, Plain paper, Thick paper, Colour paper,  
Recycled paper, Pre-punched paper

**Paper Deck Unit-F1:**  
Thin paper, Plain paper, Thick paper, Colour paper,  
Recycled paper, Pre-punched paper

\*Use only A4 transparencies made especially for multi-functional device

Supported Media Sizes  
**Cassette 1:**

Standard size : B4, A4, A4R, B5, B5R, A5R  
Custom Size : Min. 139.7 x 182 mm up to 297 x 390 mm

**Cassette 2:**  
Standard size : A3, B4, A4, A4R, B5, B5R, A5R, Foolscap,  
India Legal, F4A  
Custom Size : Min. 139.7 x 182 mm up to 297 x 431.8 mm

**Cassette Feeding Unit-A1 (3/4):**  
Standard size : A3, B4, A4, A4R, B5, B5R, A5R, Foolscap,  
India Legal, F4A  
Custom Size : 139.7 x 182 mm up to 297 x 431.8 mm

**High Capacity Cassette Feeding Unit-B1: A4**

**Paper Deck Unit-F1: A4, B5**

**Multi-Purpose Tray:**  
Standard size : A3, B4, A4, A4R, B5, B5R, A5R, Foolscap,  
India Legal, F4A  
Custom Size : 98 x 148 mm up to 297 x 431.8 mm

Supported Media Weights  
CASSETTES : 60 to 128 gsm  
MULTI-PURPOSE TRAY : 52 to 220 gsm  
DUPLEX : 60 to 105 gsm

Warm-up Time  
From Power On\* : 24 Seconds or Less  
\*Time between device power-on and when the start key is enabled  
(Force Hold print)

From Deep Sleep Mode : 10 Seconds or Less  
Quick Startup Mode : 4 seconds or less\*\*  
\*\* If <Quick Startup Settings for Main Power> is set to "On", it takes 4  
seconds until the key operation on the touch panel display is available  
after turning on the main power of the machine. Depending on the  
situations, the machine does not startup quickly.

Dimensions (W x D x H)  
With SINGLE PASS DADF-A1: 587 x 740 x 945 mm  
With DADF-AV1: 587 x 750 x 926 mm

Installation Space (W x D)  
Basic : 889 x 1171.9 mm (with SINGLE PASS  
DADF-A1 + Multi-purpose tray open +  
Cassette Drawers open)  
889 mm x 1181.9 mm (with DADF-AV1 +  
Multi-purpose tray open + Cassette  
Drawers open)  
Fully Configured : 1,811 mm x 1,269.9 mm (with SINGLE PASS  
DADF-A1 + PAPER DECK UNIT-F1 +  
BOOKLET FINISHER-Y1 + Cassette Drawers  
open)  
1,811 mm x 1,279.9 mm (with DADF-AV1 +  
PAPER DECK UNIT-F1 + BOOKLET  
FINISHER-Y1 + Cassette Drawers open)

Weight including the toner bottle  
Approx. 86.6kg (with SINGLE PASS DADF-A1)  
Approx. 81.3kg (with DADF-AV1)

## Print Specifications

Printing Method  
Monochrome laser beam printing

Print Speed iR-ADV 4551i 51 ppm (A4) 25 ppm (A3)  
iR-ADV 4545i 45 ppm (A4) 22 ppm (A3)  
iR-ADV 4535i 35 ppm (A4) 22 ppm (A3)  
iR-ADV 4525i 25 ppm (A4) 15 ppm (A3)

Print Resolution  
Up to 1,200 dpi x 1,200 dpi

Page Description Languages  
PFR II (Standard), PCL6 (Standard), Adobe PS 3 (Option)

Double Sided Printing  
Automatic (Standard)

Direct Print  
Direct printing available from USB memory key,  
Advanced box, Remote UI and Web Access\*  
Supported File Types: PDF, TIFF, JPEG, XPS

\*Only PDF print from websites is supported.

Fonts  
PCL fonts: 93 Roman, 10 Bitmap fonts, 2 OCR fonts,  
Andalé Mono WT J/K/S/T\* (Japanese, Korean,  
Simplified and Traditional Chinese),  
Barcode fonts\*\*

\*Requires optional PCL INTERNATIONAL FONT SET-A1

\*\*Requires optional BARCODE PRINTING KIT-D1

PS fonts: 136 Roman

Operating System  
UFRL: Windows Vista/Server 2008/Windows 7/Server 2008  
R2/ Windows 8/Server 2012/Windows 8.1/Server  
2012 R2/ Windows 10, MAC OS X (10.6.8 or later)

PCL: Windows Vista/Server 2008/Windows 7/Server 2008  
R2/ Windows 8/Server 2012/Windows 8.1/Server  
2012 R2/ Windows 10

PS: Windows Vista/Server 2008/Windows 7/Server 2008  
R2/ Windows 8/Server 2012/Windows 8.1/Server 2012  
R2/ Windows 10, MAC OS X (10.6.8 or later)

PPD: MAC OS 9.1 or later, MAC OS X (10.3.9 or later),  
Windows Vista/Windows 7/Windows 8/Windows 8.1/  
Windows 10

## Copy Specifications

Copy Speed (BW/Colour)  
iR-ADV 4551i 51 ppm (A4) 25 ppm (A3)  
iR-ADV 4545i 45 ppm (A4) 22 ppm (A3)  
iR-ADV 4535i 35 ppm (A4) 22 ppm (A3)  
iR-ADV 4525i 25 ppm (A4) 15 ppm (A3)

\*First-Copy-Out Time (A4)  
\* 20 °C to 30 °C Environment  
iR-ADV 4551i: Approx. 3.7 seconds or less  
iR-ADV 4545i/4535i: Approx. 3.8 seconds or less  
iR-ADV 4525i: Approx. 5.2 seconds or less

Copy Resolution  
Reading : 600 dpi x 600 dpi  
Printing : 1,200 dpi x 1,200 dpi  
Multiple Copies  
Up to 999 copies

Copy Exposure  
Automatic or Manual (10 Levels)

Magnification  
25% - 400% (1% Increments)

Preset Reductions  
25%, 50%, 61%, 70%, 81%, 86%

Preset Enlargements  
115%, 122%, 141%, 200%, 400%

## Scan Specifications

Type  
Single-pass Duplexing Automatic Document Feeder or  
Duplexing Automatic Document Feeder

Document Feeder Paper Capacity  
SINGLE PASS (SP) DADF-A1: 150 Sheets (80 gsm)  
DADF-AV1: 100 Sheets (80 gsm)

Document Feeder Supported Media Sizes  
SP DADF-A1: A3, B4, A4, A4R, B5, B5R, A5, A5R, B6R  
DADF-AV1: A3, B4, A4, A4R, B5, B5R, A5, A5R, B6

Document Feeder Supported Media Weights  
**SP DADF-A1**  
Single-sided scanning: 38 to 157 gsm (BW)  
64 to 157 gsm (CL)  
Double-sided scanning: 50 to 157 gsm (BW)  
64 to 157 gsm (CL)

**DADF-A1**  
Single-sided scanning: 38 to 128 gsm (BW)  
64 to 128 gsm (CL)  
Double-sided scanning: 50 to 128 gsm (BW)  
64 to 128 gsm (CL)

Pull Scan Spec  
Color Network ScanGear2. For both Twain and WIA.  
Supported OS: Windows Vista/7/8/8.1/10 Server 2008/  
Server 2008 R2/Server 2012/Server 2012 R2

Scan Resolution  
100 x 100 dpi, 150 x 150 dpi, 200 x 100 dpi, 200 x 200 dpi,  
200 x 400 dpi, 300 x 300 dpi, 400 x 400 dpi, 600 x 600 dpi

Platen Acceptable Originals  
Platen: Sheet, Book, 3-Dimensional Objects [Up to 2kg]  
Paper Size: A3, B4, A4, A4R, B5, B5R, A5, A5R

Scan Speed (A4)  
**SP DADF-A1:**  
Single-sided Scanning (BW): 80 ipm (300pi)/80 ipm (600 dpi)  
Single-sided Scanning (Colour): 80 ipm (300pi)/60 ipm (600 dpi)  
Double-sided Scanning (BW): 160 ipm (300pi)/150 ipm (600 dpi)  
Double-sided Scanning (Colour): 160 ipm (300pi)/80 ipm (600 dpi)

**DADF-AV1:**  
Single-sided Scanning (BW): 70 ipm (300pi) / 51 ipm (600 dpi)  
Single-sided Scanning (Colour): 70 ipm (300pi) / 51 ipm (600 dpi)  
Double-sided Scanning (BW): 35 ipm (300pi) / 25.5 ipm (600 dpi)  
Double-sided Scanning (Colour): 35 ipm (300pi) / 25.5 ipm (600 dpi)

Double sided scanning  
2-sided to 2-sided (Automatic)

## Send Specifications

Optional/ standard  
Standard on all models

Destination  
E-mail/Internet FAX (SMTP), SMB, FTP, WebDAV, Mail Box,  
Super G3 FAX(Optional), IP Fax(Optional)

Colour Mode  
Automatic-Colour Select (Full Colour/Grayscale),  
Automatic-Colour Select (Full Colour/Black-and-White),  
Full colour, Grayscale, and Black-and-White

Address Book  
LDAP (2,000)/Local (1,600)/One-touch (200)

Send Resolution  
100 x 100 dpi, 150 x 150 dpi, 200 x 100 dpi, 200 x 200 dpi,  
200 x 400 dpi, 300 x 300 dpi, 400 x 400 dpi, 600 x 600 dpi

Communication Protocol  
File : FTP, SMB 3.0, WebDAV  
E-mail/Fax : SMTP, POP3, I-Fax (Simple, Full)

File Format  
Standard : JPEG, TIFF, PDF/XPS (Compact),  
PDF (PDF/A-1b, Optimize for Web, Apply Policy)  
Optional : PDF (Trace&Smooth, Encrypted), PDF/XPS  
(Digital Signature, Searchable),  
Office Open XML (Powerpoint, Word)

## Fax Specifications

Optional/ Standard : Optional on all models

Maximum Number of Connection Lines : 4

Modem Speed : Super G3: 33.6 kbps  
G3 : 14.4 kbps

Compression Method	MH, MR, MMR, JBIG
Resolution	400 x 400 dpi, 200 x 400 dpi, 200 x 200 dpi, 200 x 100 dpi
Sending/Recording Size	A5 and A5R* to A3 * Sent as A4
FAX Memory	Up to 30,000 pages
Speed Dials	Max. 200
Group Dials/Destinations	Max. 199 dials
Sequential Broadcast	Max. 256 addresses
Memory Backup	Yes

## Store Specifications

Mail Box (Number supported)  
100 User Inboxes, 1 Memory RX Inbox,  
50 Confidential Fax Inboxes  
30,000 Maximum Pages Stored

Advanced Box  
Communication Protocol: SMB or WebDAV  
Supported Client PC: Windows (Windows Vista/7/8/8.1/10)  
Concurrent Connections (Max.): SMB: 64, WebDAV: 3  
(Active Sessions)

Advanced Box Available Disc Space  
Approx. 16GB (Standard HDD)  
Approx. 480GB (1TB HDD)

Memory Media  
Standard: USB Memory

## Security Specifications

Authentication  
Standard : Picture Login Authentication,  
User Authentication, Department ID  
Authentication, (Device and Function  
Level Login), Access Management System  
Optional: My Print Anywhere secure print  
(Requires uniFLOW)

Data  
Standard: Trusted Platform Module (TPM), Hard Disk  
Password Lock, Hard Disk Drive Erase, Hard  
Disk Drive Encryption (FIPS 140-2 Validated),  
Mail Box Password Protection

Optional : Hard Disk Drive Mirroring, Hard Disk Drive  
removal, IEEE 2600.2 Common Criteria  
Certification.

Network  
Standard : IP/Mac Address Filtering, IPSEC, TLS Encrypted  
Communication, SNMP V3.0, IEEE 802.1X, IPv6,  
SMTP Authentication, POP Authentication  
before SMTP

Document  
Standard : Secure Print, Force Hold Print  
Optional : Encrypted PDF, Encrypted Secure Print,  
User and Device Signatures, Secure  
Watermarks, Document Scan Lock

## Environmental Specifications

Operating Environment  
Temperature: 10 to 30 °C  
Humidity: 20 to 80 % RH (no condensation)

Power Requirements  
iR-ADV 4551i: 220-240V(±10%), 50/60 Hz (±2 Hz) 5.6A  
iR-ADV 4545i: 220-240V(±10%), 50/60 Hz (±2 Hz) 5.2A  
iR-ADV 4535i: 220-240V(±10%), 50/60 Hz (±2 Hz) 5.2A  
iR-ADV 4525i: 220-240V(±10%), 50/60 Hz (±2 Hz) 4.3A

Power Consumption  
Maximum: 1.5 kW  
Standby: Approx. 37 W\*  
Sleep mode: Approx. 0.9 W\*\*  
\*Reference Value  
\*\*0.9W sleep mode is not available in all circumstances due to certain settings.

## Paper Supply Options

### PAPER SUPPLYING UNIT

#### Cassette Feeding Unit-A1

Paper Size : A3, B4, A4, A4R, B5R, B5, A5R  
Custom size : 139.7 mm x 182.0 mm to  
297.0 to 431.8 mm

Paper Weight : 60 to 128 gsm  
Paper Capacity : 550 sheets x 2 (80 gsm)  
Power Source : From the Main Unit  
Dimensions (WxDxH) : 565 x 650 x 248 mm\*\*  
Weight : Approx. 23.5 kg

\*\*When attached with the Main Unit

#### High Capacity Cassette Feeding UNIT-B1

Paper Size : A4  
Paper Weight : 60 to 128 gsm  
Paper Capacity : 2,450 sheets (80 gsm)  
Power Source : From the Main Unit  
Dimensions (WxDxH) : 565 x 650 x 248 mm\*\*  
Weight : Approx. 28 kg

\*\*When attached with the Main Unit

#### Paper Deck Unit-F1

Paper Size : A4, B5  
Paper Weight : 60 to 128 gsm  
Paper Capacity : 2,700 sheets (80 gsm)  
Power Source : From the Main Unit  
Dimensions (WxDxH) : 400 x 630 x 440 mm  
Weight : Approx. 31 kg

## Software and Printer Management

Remote management tools  
eMaintenance: Compatible with eMaintenance  
services via embedded RDS  
(Enables meter capture, automatic  
consumables management,  
remote diagnostics and reporting for  
service providers to offer efficient, fast  
and proactive maintenance)

Content Delivery System: Allows the Remote distribution of  
firmware, iR options and MEAP  
applications; Remote User Interface  
(RUI) Web-based interface to each  
device that helps to provide remote  
device management and control.

iW Management Console: Server-based software for centralised  
management of a fleet of devices  
(includes monitoring or consumables,  
status monitoring and alerts, distribution  
of address books, configuration  
settings, firmware and MEAP  
applications, meter capture and  
reporting, driver and resource  
management)

Scanning software  
Network ScanGear: TWAIN-compliant scanner driver that  
enables computers on a network to  
use the pull scan functionality of the  
device.

Platform  
MEAP (Multifunctional Embedded Application Platform):  
A powerful JAVA Embedded Platform for Canon devices  
which provides tight coupling between a range of  
software solutions and the device.

Document Publishing  
iW DESKTOP: Powerful print publishing software which  
easily combines documents from  
different sources and file formats,  
applies finishing with preview and  
templates to create professional looking  
documents. Includes PDF creation,  
annotation and compression  
capabilities for simple digital workflows  
such as proofing and authorization.

## Hardware Accessories

For full information on options available for the iR-ADV  
4500i series, please refer to the specification tables on  
your local Canon web site.

To arrange for a demonstration, simply contact any of our offices below.

### SOUTH & SOUTHEAST ASIA REGIONAL HEADQUARTERS

Canon Singapore Pte. Ltd. | 1 Fusionopolis Place #15-01 Galaxis Singapore 138522  
Tel: 65-6799 8888 | Fax: 65-799-8882 | [www.canon-asia.com](http://www.canon-asia.com) | [www.canon.com.sg](http://www.canon.com.sg)



Partner / Dealer Stamp



This document is for information purpose only and the contents are subject to change without notice. Product options, name and availability may vary by regions. Nothing in this document should be construed as a warranty. We expressly disclaim any liability or contractual obligations with respect to this document.

Canon, imageRUNNER, imageRUNNER ADVANCE, imageCHIP, RAPID Fusing System, MEAP, eMaintenance, iW, Business can be simple and get Smart get genuine are trademarks of Canon Inc. and/or its affiliates. "MEAP" is a trademark of CANON Inc., referring to an "application platform" for Canon multifunction and single function printers. Other names may be the trademarks of their respective owners. uniFLOW, eCopy and Therefore are independent party software distributed by Canon Singapore Pte Ltd.

Adobe, PostScript, PostScript 3 and the PostScript logo are trademarks of Adobe Systems Incorporated

0206W041 @ 2017 Canon Singapore Pte. Ltd.  
All rights reserved. Printed in Singapore.